

INSTALLATION *guide*



inteo *LIGHTING module RTS*

The LIGHTING module RTS is a radio receiver dedicated to control an incandescent or halogen lamp with an RT or RTS control (no lamp with gear). Up to twelve different controls can be memorized in the memory of the LIGHTING module RTS allowing individual, group and master commands.

This device must be installed and programmed by qualified installers for whom this instruction is intended.

1 Characteristics

- Main supply : 220-240V ~
- Class 1 product
- Protection index : IP44.
- Max load : 500 W.
incandescent or halogen lamps.
- Radio frequency : 433.42 MHz
- Operating temp. : -30°C to +80°C



Hereby, SOMFY declares that this equipment is in compliance with the essential requirements and other relevant provisions of Directive 1999/5/EC.
A Declaration of Conformity is available at the web address www.somfy.com Heading CE

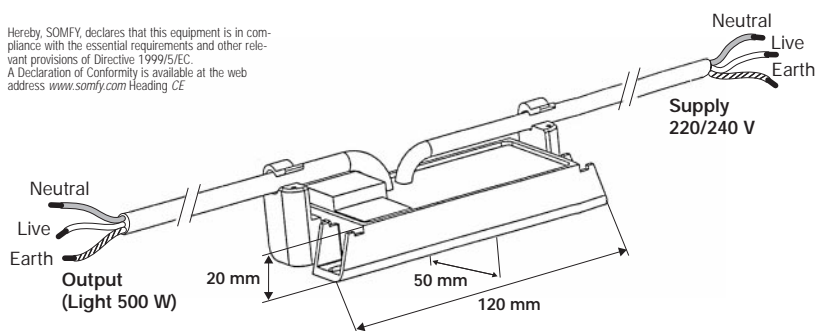
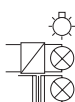

2 Installation

The LIGHTING module RTS can be installed by using screws or clamp collars depending on the support.

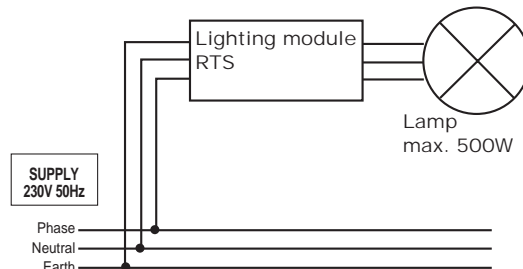
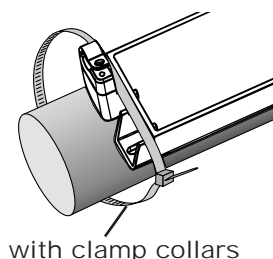
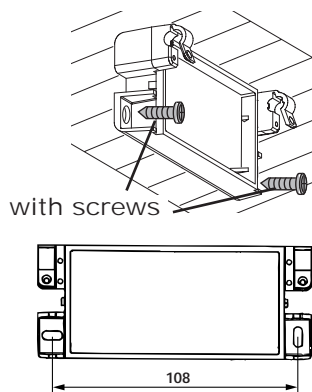

Recommendation of mounting for better radio reception :

- minimum distance between LIGHTING module RTS and the floor : 1,5 m.
- minimum distance between a LIGHTING module RTS and a radio transmitter : 30 cm.
- minimum distance between two LIGHTING module RTS : 20 cm.

Warning : cordless radio equipment (e.g. headphones) in 433MHz can affect the functioning of the LIGHTING module RTS.

3 Programming and operating

3.1 Record the first control

1 Set the lighting module RTS in its programming mode :

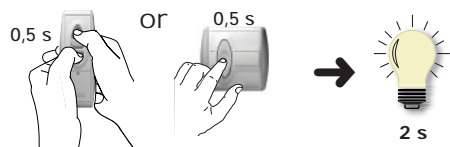

Power the installation then,
with a RTS control : press simultaneously on the ▼ and ▲ buttons.
with a RT control : press on the front button.
 → The lamp lights during 2 secs., the LIGHTING module RTS enters in programming mode.
 You can control the lamp momentarily by pressing on the ▲ button (or front button).

2 Record the control :

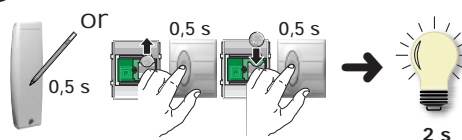

RTS control : press briefly the "prog" button of the control.
RT control : remove the battery, press briefly the button, replace the battery and press again briefly the button of the control.
 → The lamp lights during 2 secs. again, the control is recorded in the LIGHTING module RTS.

3.2 Operating

With a RTS control

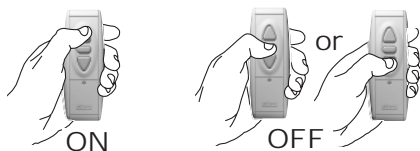

Press briefly on the ▲ of the RTS control to switch the lamp ON.
Press briefly the ■ or ▼ buttons to switch the lamp OFF.

With a RT control



Press briefly on the front button of the RT control to switch the lamp ON or OFF.

3.3 Record a new control

- 1 Set the lighting module RTS in its programming mode with an already recorded control :

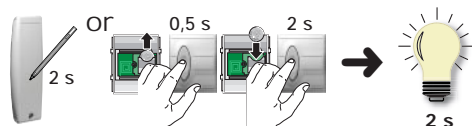

with a RTS control : press for more than **2 sec.** on the "prog" button.

with a RT control : remove the battery, press briefly the button, replace the battery and press for more than **2 sec.** on the button.

→ The lamp switches on for 2 secs., the LIGHTING module RTS enters in programming mode.

- 2 Record the new control :

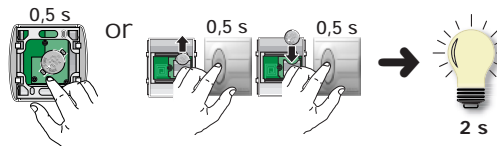

RTS control : press briefly the "prog" button.

RT control : remove the battery, press briefly the button, replace the battery and press again briefly the button.

→ The lamp switches on for 2 secs. again, the control is recorded in the LIGHTING module RTS.

3.4 Remove a control (if at least two controls have been recorded)

To remove a control from the memory of a LIGHTING module RTS, set the receiver in its programming mode with a control that you do not want to erase (see above), then press shortly the prog button of the RTS control you wish to remove (to remove an INIS RT, remove/replace the battery then press the front button).

3.5 Re-programming (if you have lost your unique control)

- 1 Make a double power cut-off of the main:

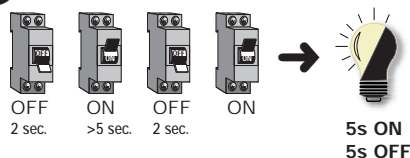

OFF 2 sec. → ON 5 sec. → OFF 2 sec. → ON

→ The lamp blinks (5s.ON/5s.OFF) indicating that the LIGHTING module RTS is ready to be re-programmed. This mode last 2 minutes.

Warning :

All of the receivers connected on the same network will be then ready to be re-programmed. To exclude the non concerned receivers, press briefly the push button of their respective control after the double power cut-off.

- 2 Take the new control you want to record :

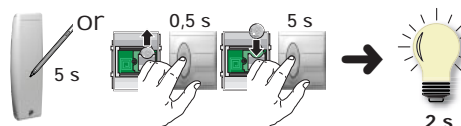

RTS control : press for more than **5 sec.** on the "prog" button.

RT control : remove the battery, press briefly the button, replace the battery and press for more than **5 sec.** on the button.

→ The lamp lights during 2 secs. indicating that the LIGHTING module RTS has erased the previous control from the memory and recorded the new one.

3.6 Complete reset (back to factory configuration)

- 1 Make a double power cut-off of the main:

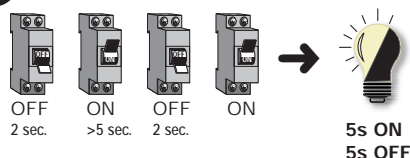

OFF 2 sec. → ON 5 sec. → OFF 2 sec. → ON

→ The lamp blinks (5s.ON/5s.OFF) indicating that the LIGHTING module RTS is ready to be re-programmed. This mode last 2 minutes.

Warning :

All of the receivers connected on the same network will be then ready to be re-programmed. To exclude the non concerned receivers, press briefly the push button of their respective control after the double power cut-off.

- 2 Take an already recorded control :

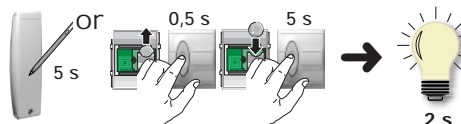

RTS control : press for more than **5 sec.** on the "prog" button.

RT control : remove the battery, press briefly the button, replace the battery and press for more than **5 sec.** on the button.

→ The lamp lights during 2 secs. indicating that the LIGHTING module RTS has been completely cleared.

No more controls are recorded and you have then to re-program the LIGHTING module RTS from the first step of programming (refer to section 3.1).

4 Trouble shooting guide

Nothing works:

- ⇒ Check the light.
- ⇒ Check the power supply.
- ⇒ Check the battery of the transmitter.
- ⇒ Check that the transmitter has been properly recorded in the LIGHTING module RTS memory (section 3).
- ⇒ Check for any other possible source of radio interferences.

Lost in your programming mode:

- ⇒ Just make a complete reset and start again.

SOMFY®