

somfy®

TaHoma® switch

Uputstvo za instalaciju

SRB

Dobrodošli!

Pokrenite TaHoma[®] switch
uređaj u nekoliko jednostavnih koraka

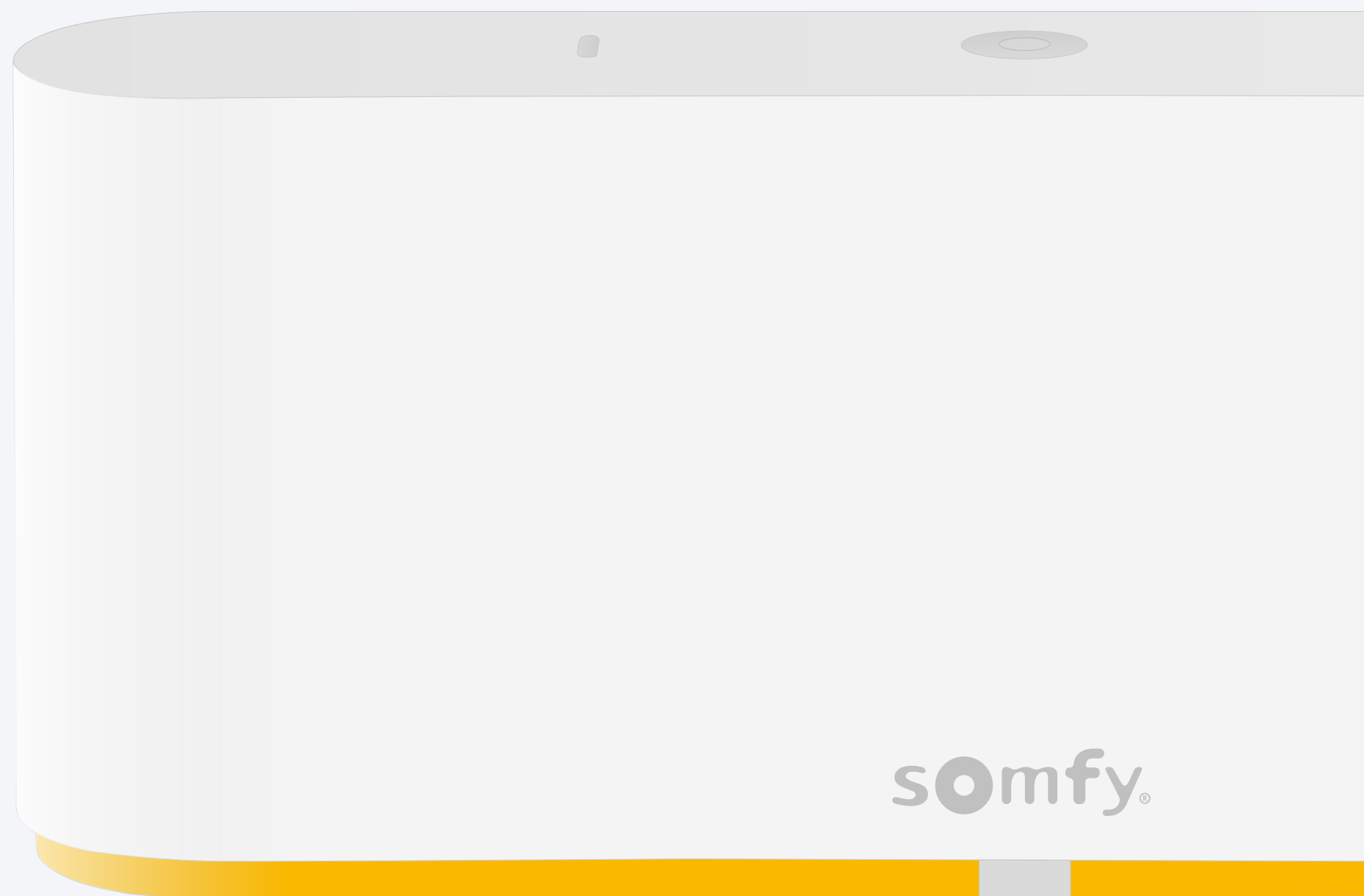

Sadržaj kompleta

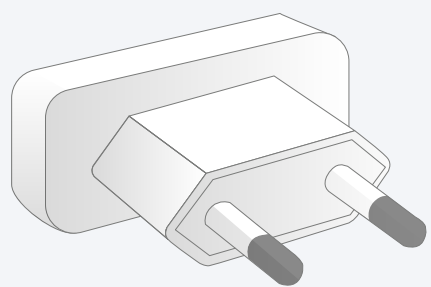
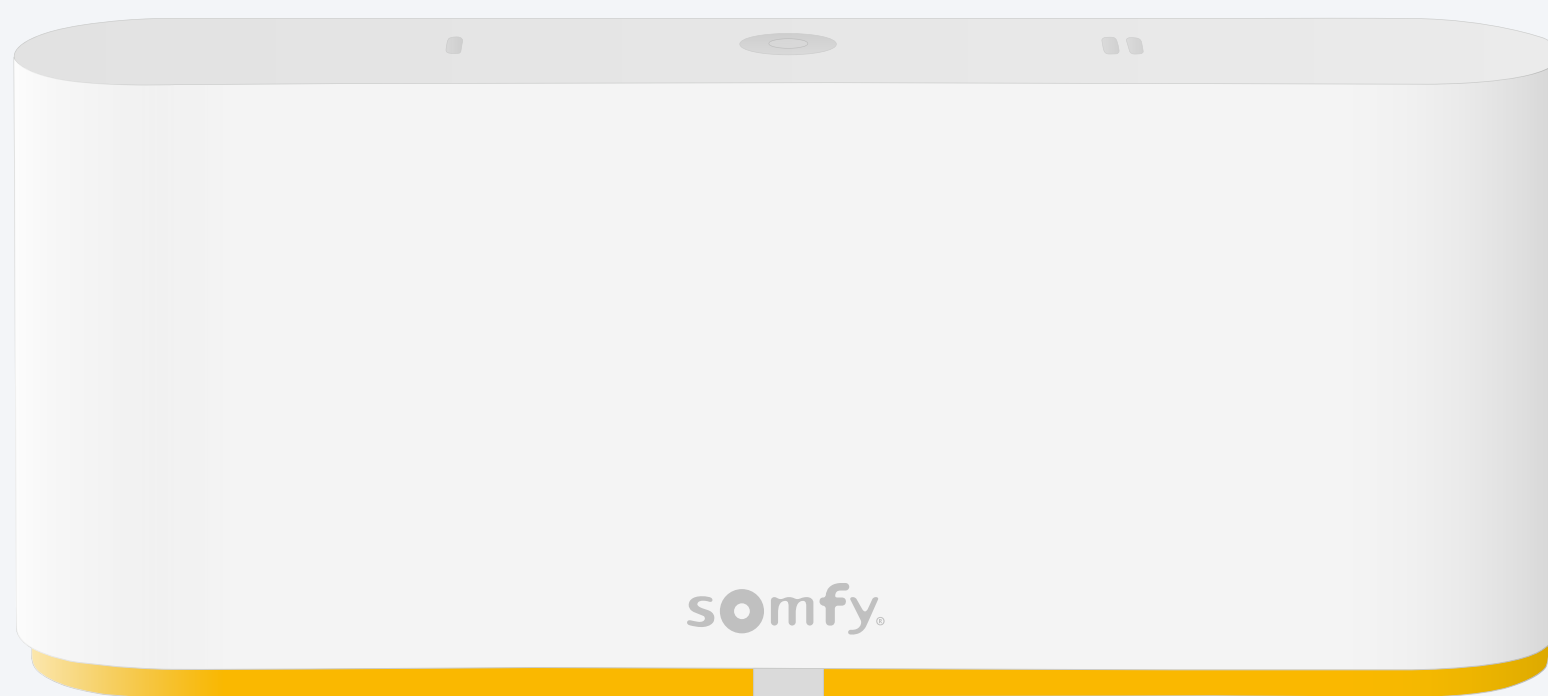

ili

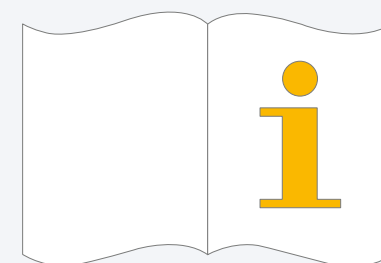
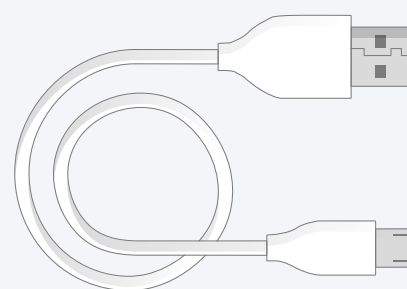
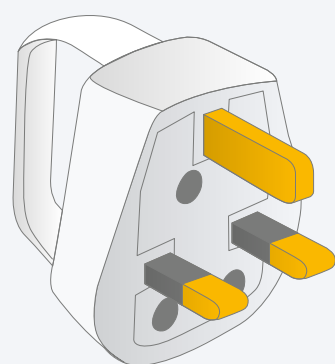

Instalirajte aplikaciju TaHoma®

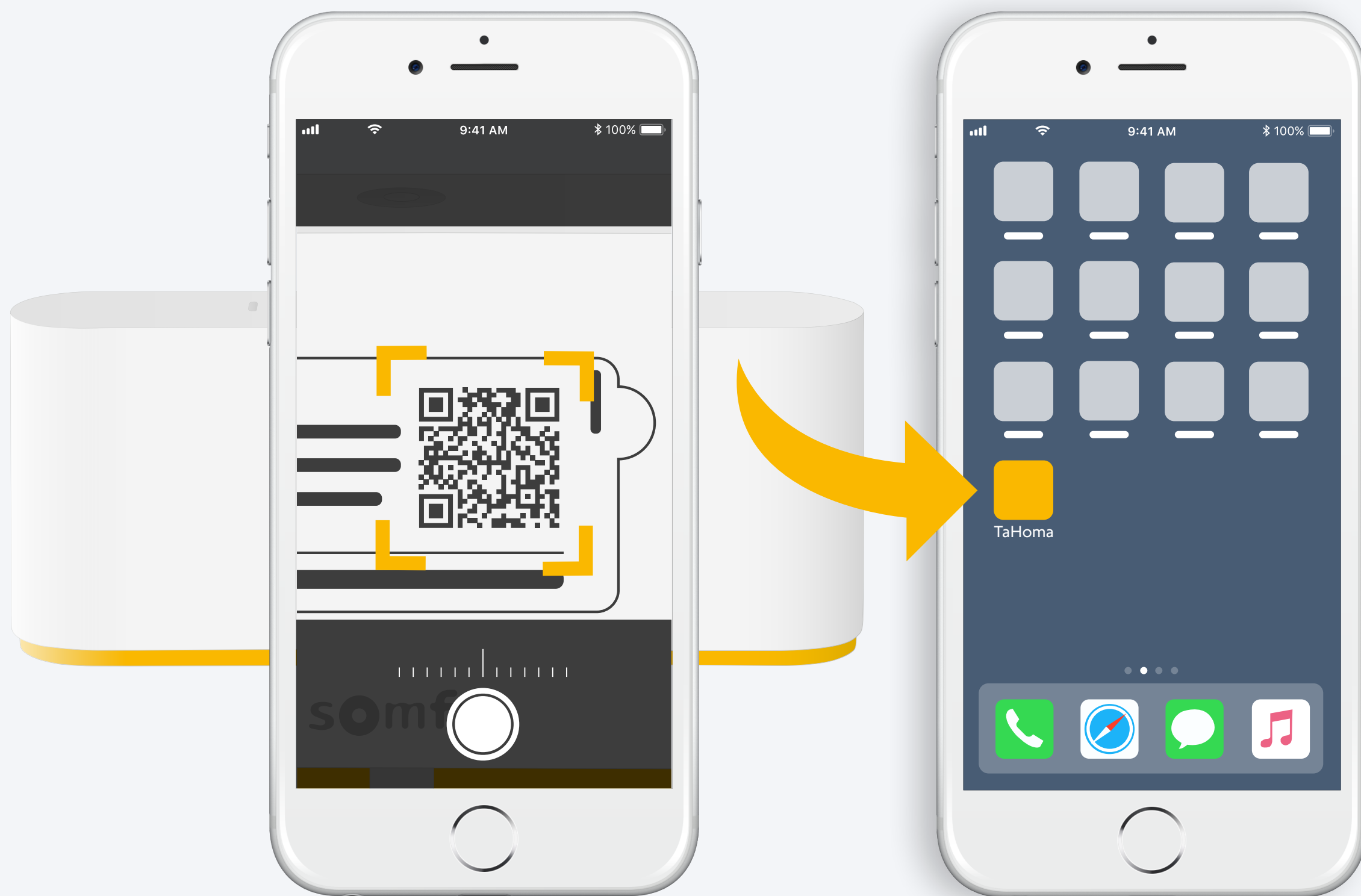

Pratite uputstva

Aplikacija TaHoma®
je instalirana

1. Pokrenite aplikaciju TaHoma®

Pokretanje

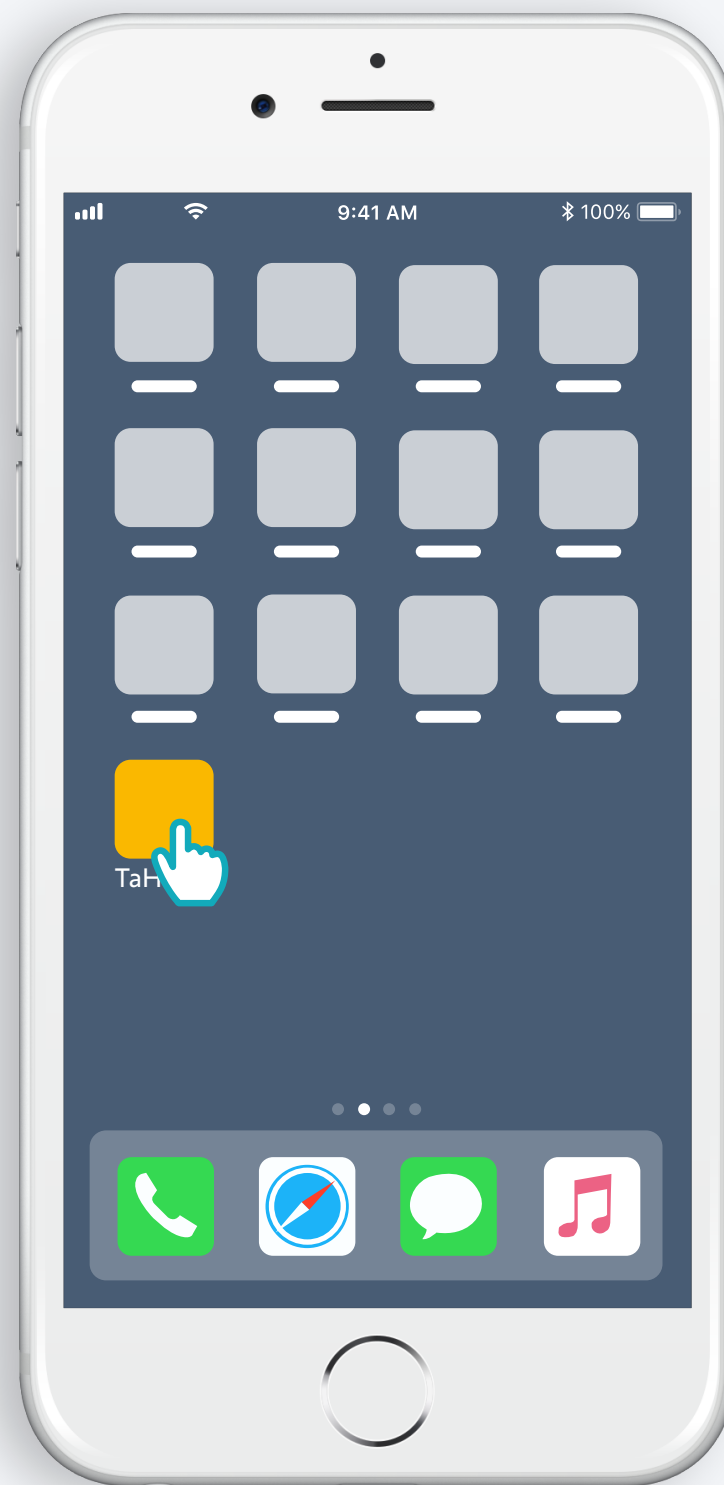

Otvorite aplikaciju TaHoma®

Pokretanje

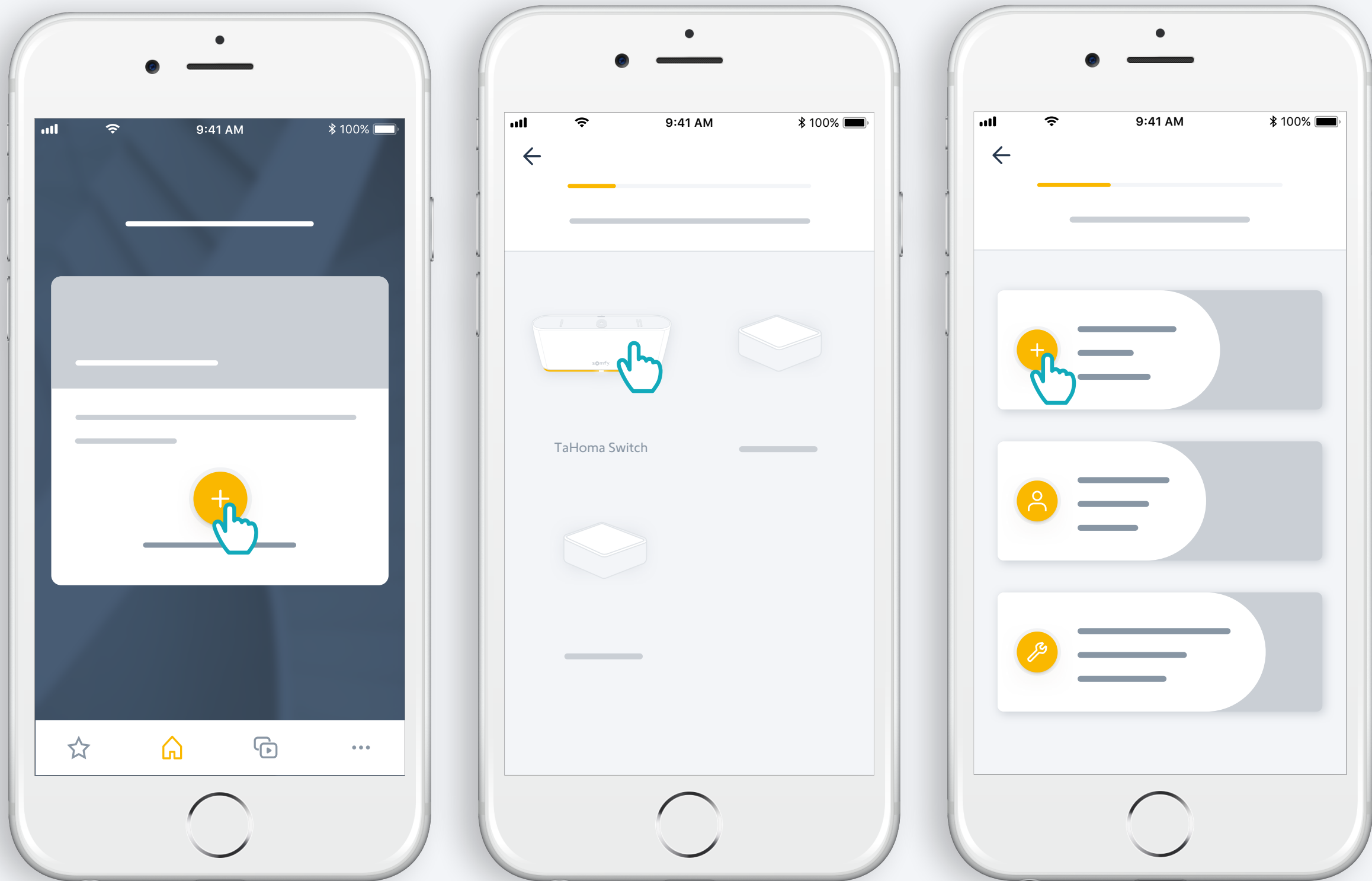

Pokrenite instalaciju TaHoma® switch uređaja

Priključivanje TaHoma[®] switch uređaja

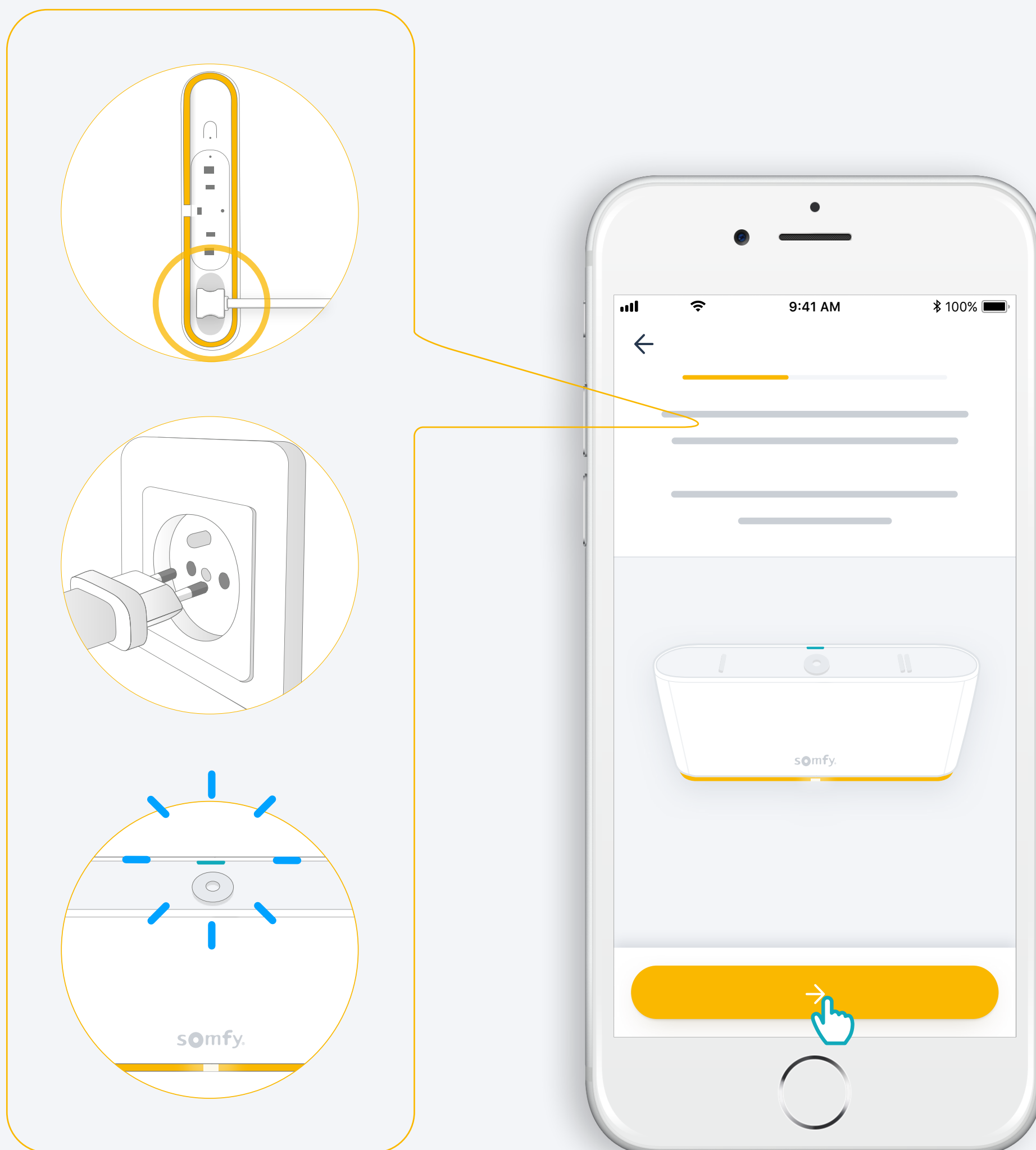

Povezivanje na Internet

Vaša WiFi mreža mora da bude na 2.4GHz i da bude osigurana lozinkom

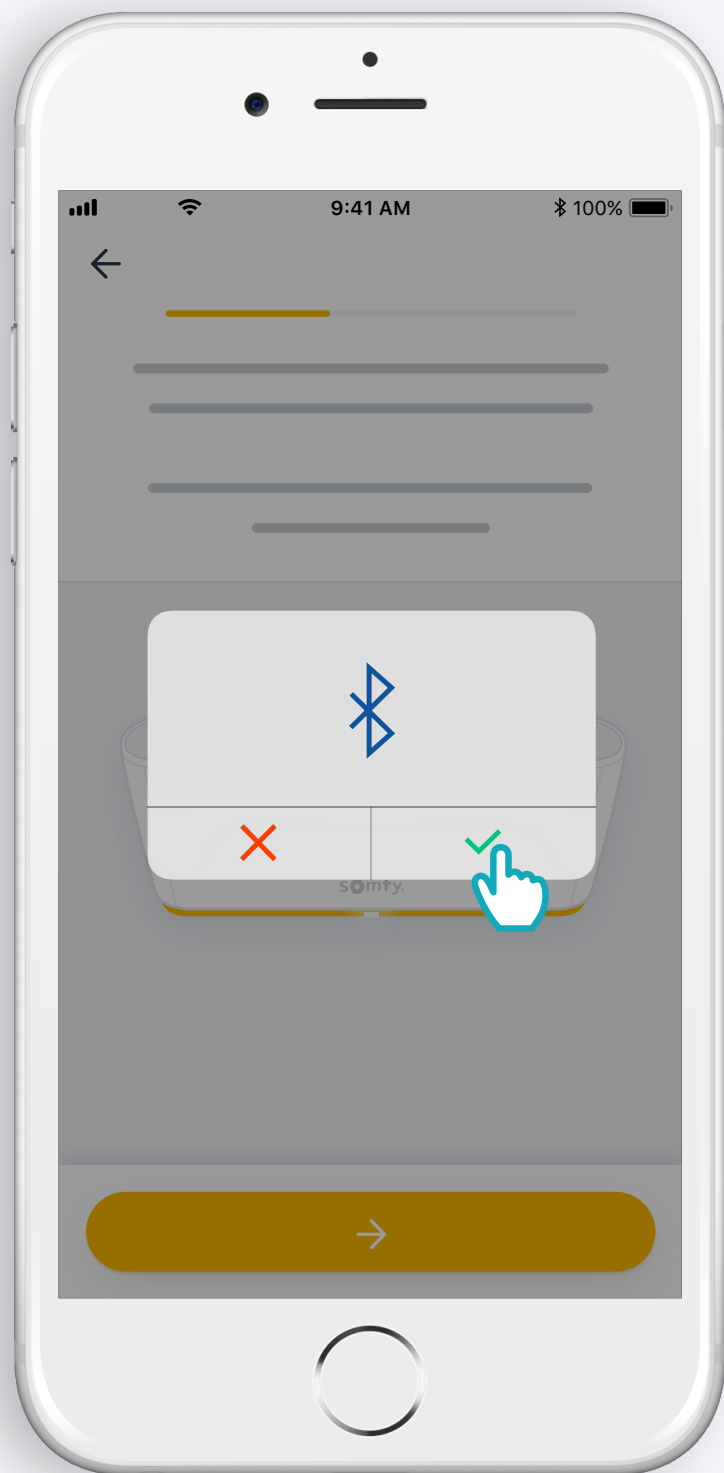

Uključite Bluetooth

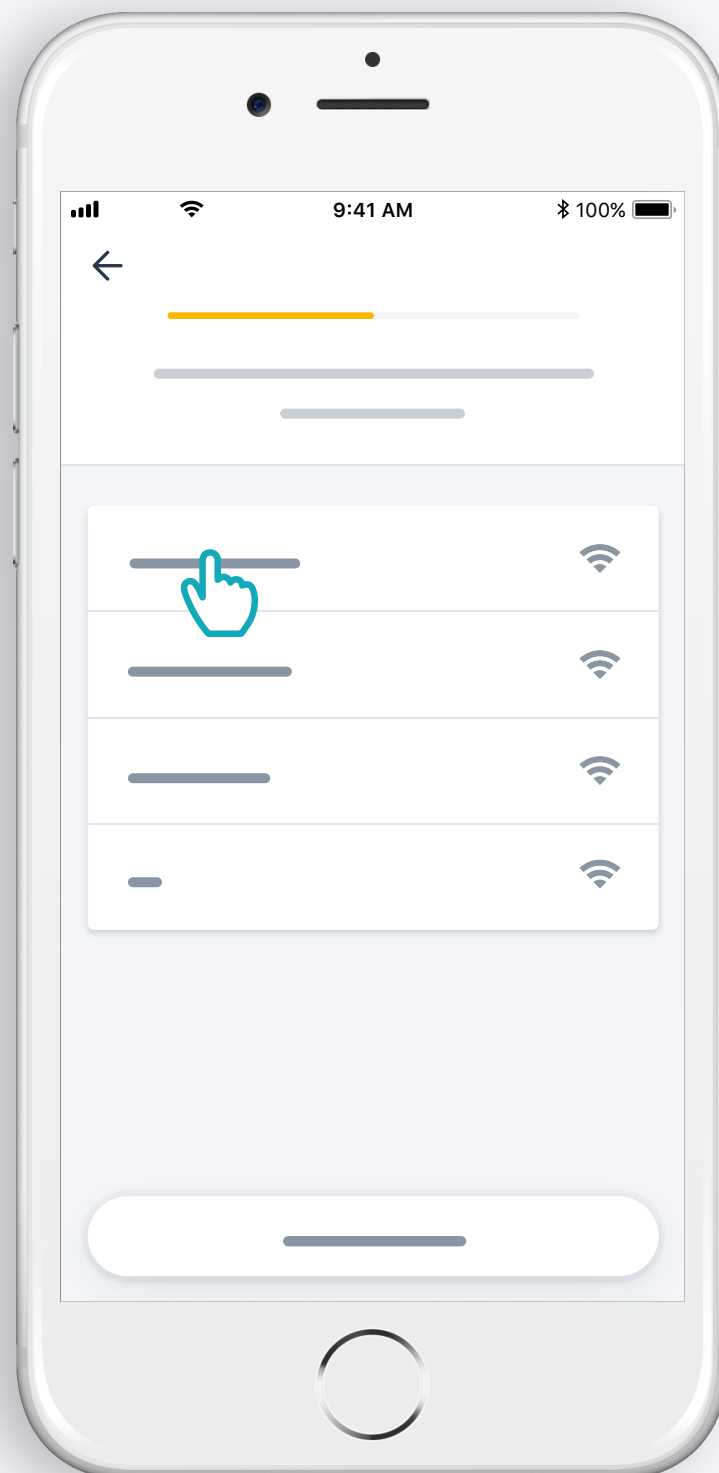

Izaberite Bluetooth mrežu i unesite lozinku

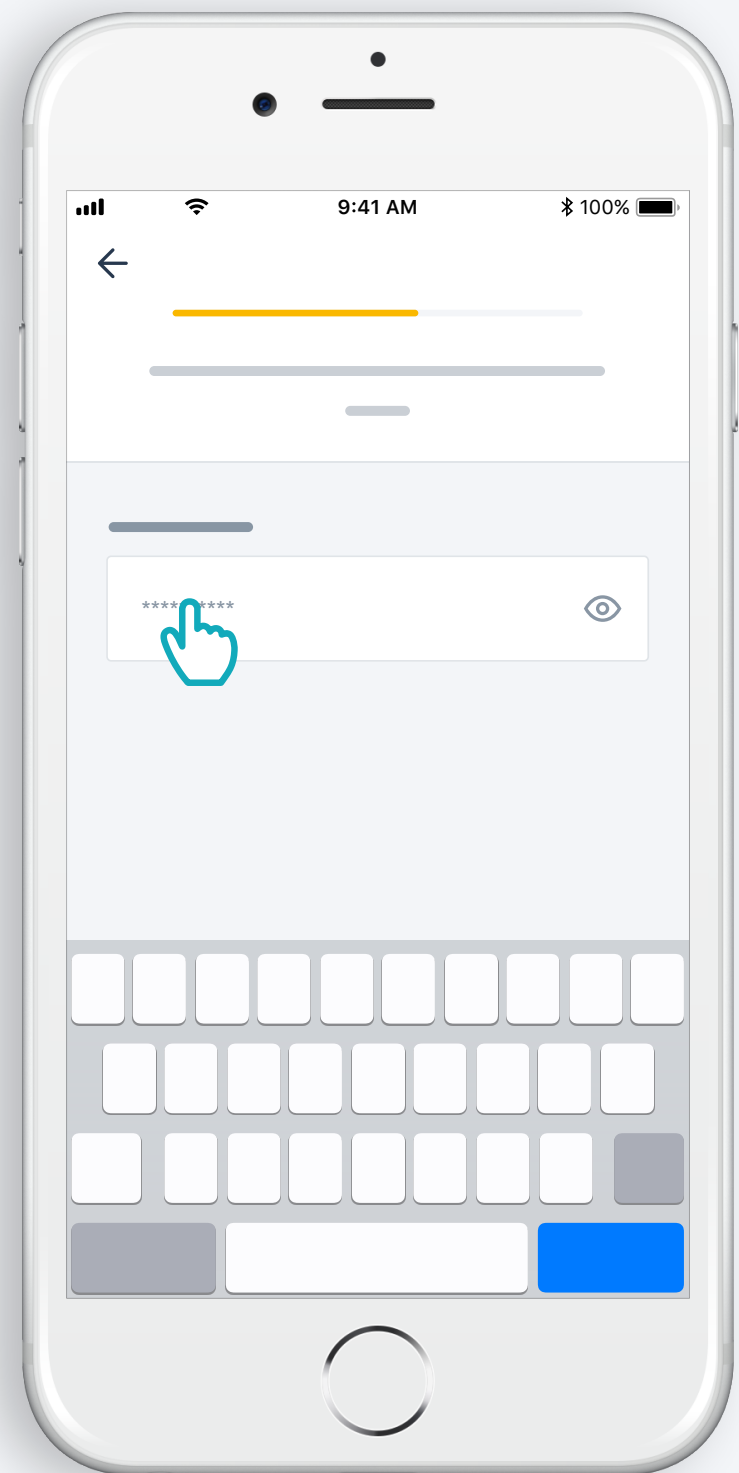

2. Kreirajte svoj nalog za aplikaciju
TaHoma[®] ili se prijavite

Kreirajte svoj nalog za aplikaciju TaHoma[®] ili se prijavite

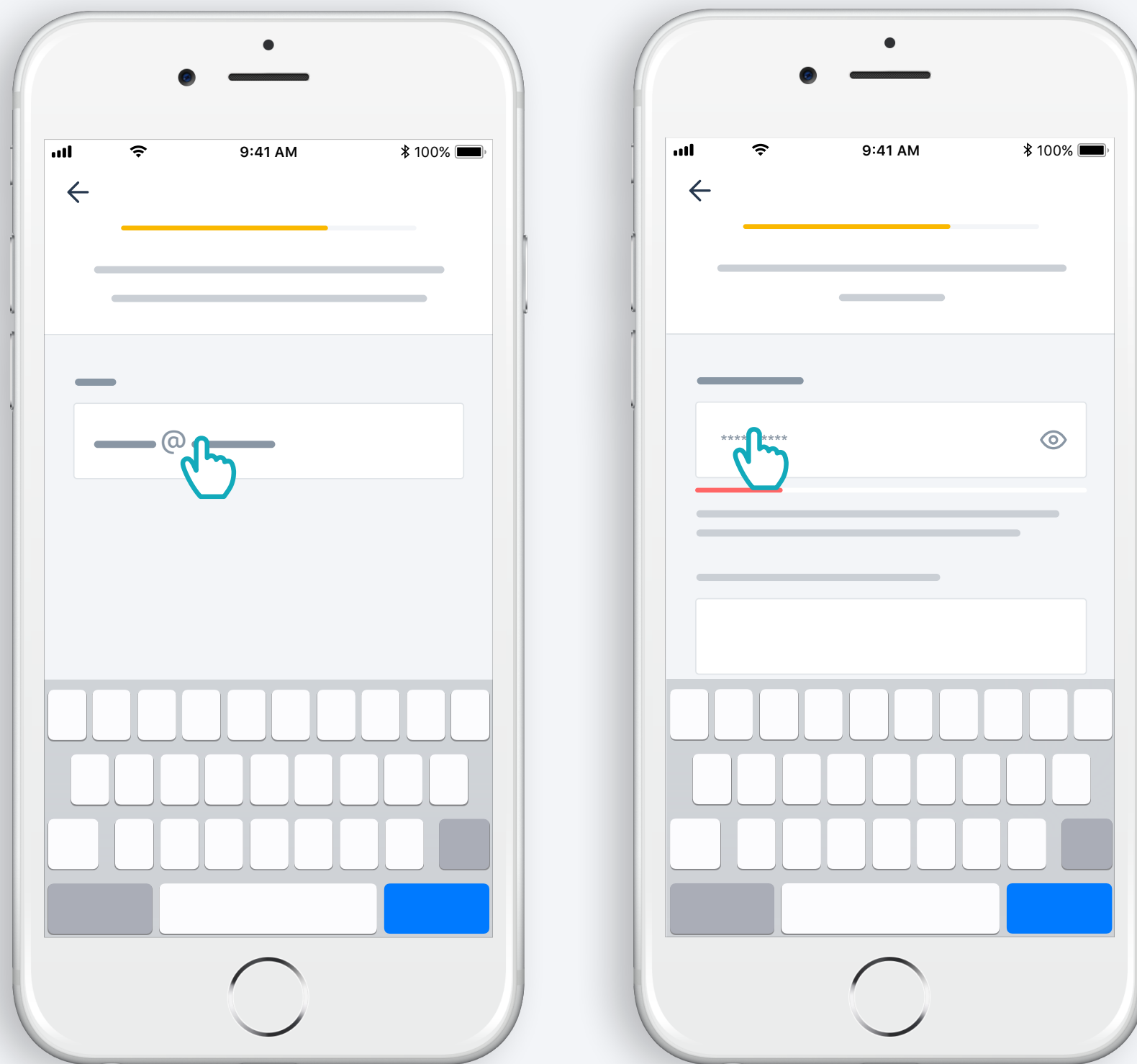

Unesite svoju adresu e-pošte i lozinku

Pratite uputstva

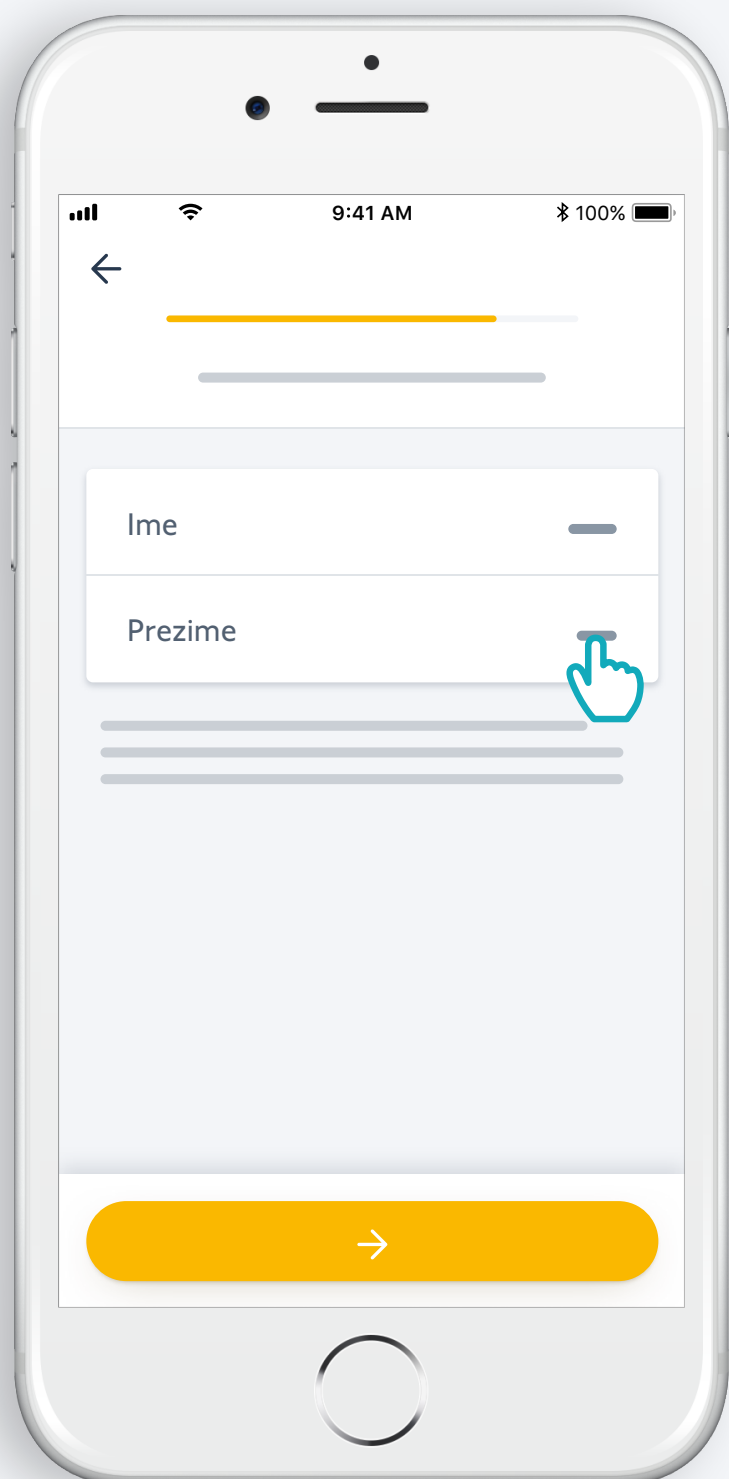

Unesite svoje ime

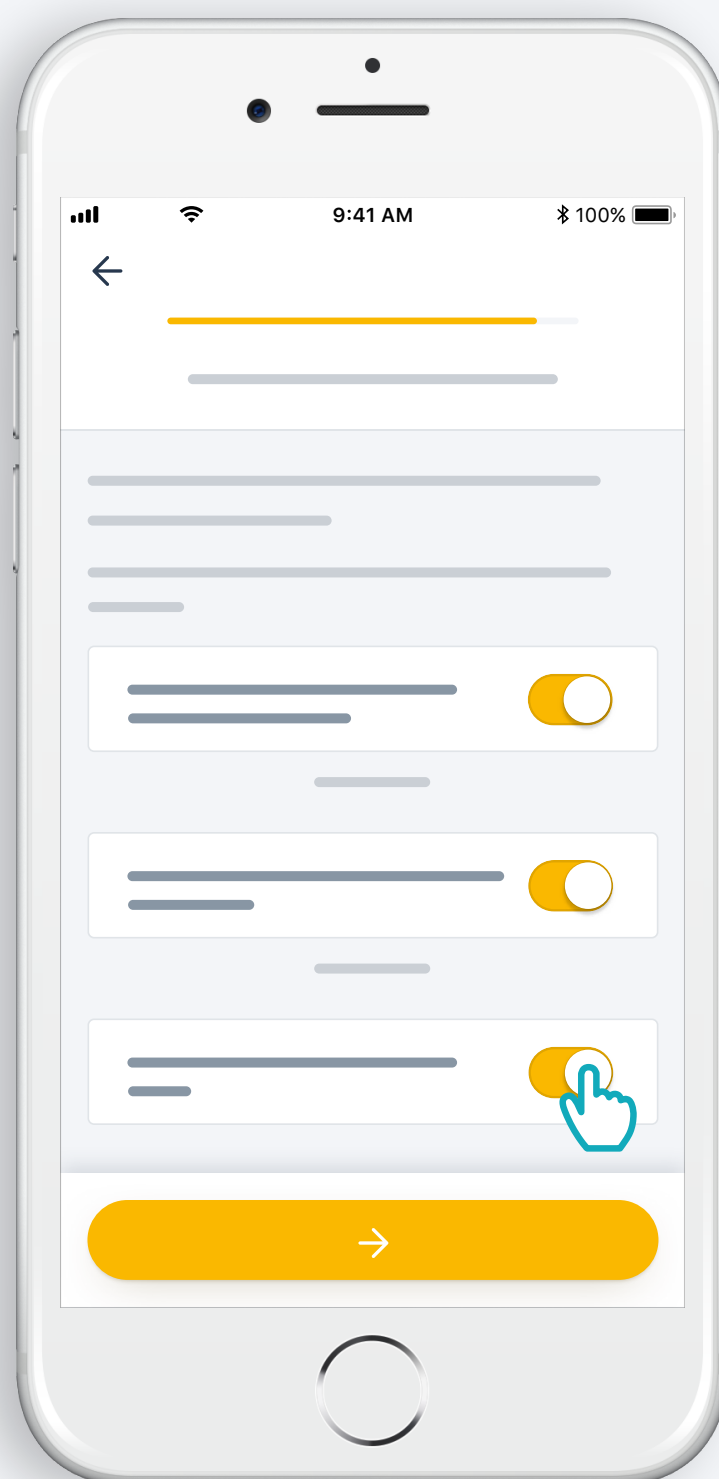

Prihvati uslove korišćenja

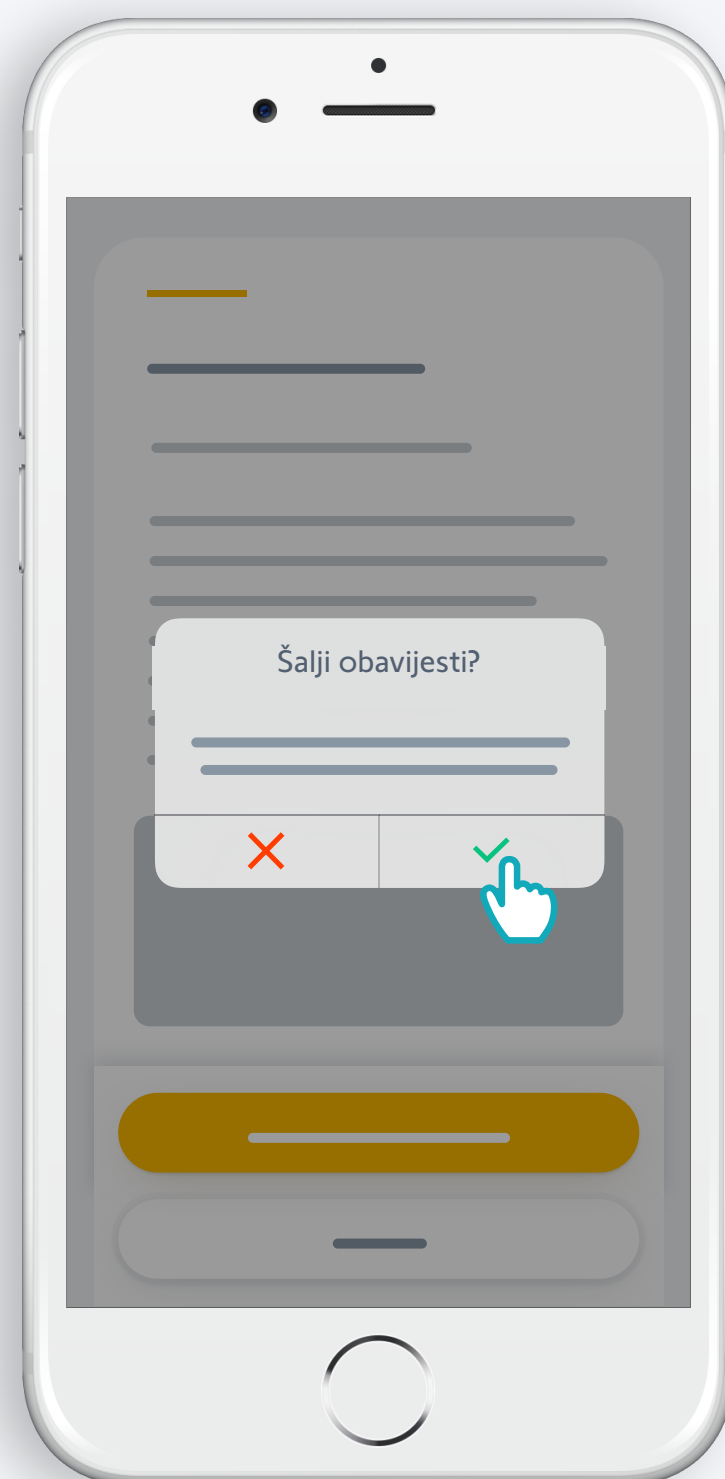

Za bolje korisničko iskustvo dozvolite obaveštenja

Čestitamo, TaHoma[®] switch je
spreman za upotrebu!

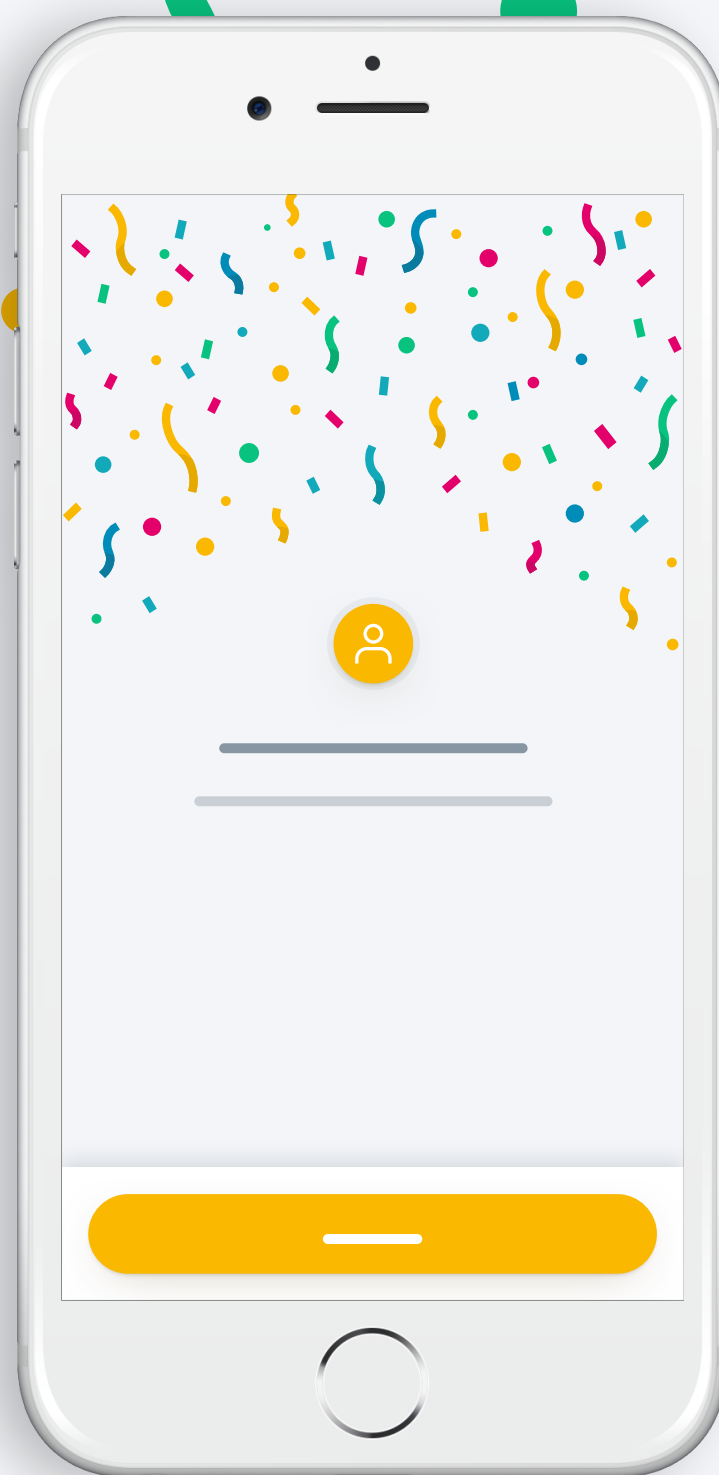

Sada:

- Dodajte proizvode
- Konfigurirajte tastere TaHoma[®] switch-a i otkrijte sve mogućnosti koje aplikacija nudi!

somfy®

5156715A